

# L J Series Mini Belt Spray Washer

Inline / Cellular Aqueous Spray Washer



**Most Versatile, Compact, Energy-Efficient System Available**

Flexible Design with Up to 3 Tanks

- Wash
- Rinse
- Rust Prevent / Seal
- Regenerative Blow Off



Return-to-Operator Robotic Load/  
 Unload Design



\* Optional Equipment

### Ideal for

- Die Cast
- Powder Metals
- Machined Parts
- Screw Machine
- Cold Heading
- Others
- Stampings
- Deep Drawn
- Castings
- Fine Blanked
- Forging
- Gears

Call: **860/828-6516**

Visit: [www.jenfab.com](http://www.jenfab.com)

Contact: [salesinfo@jenfab.com](mailto:salesinfo@jenfab.com)

**Jensen Fabricating Engineers, Inc.**

# JENFAB L J SERIES MINI BELT SPRAY WASHER

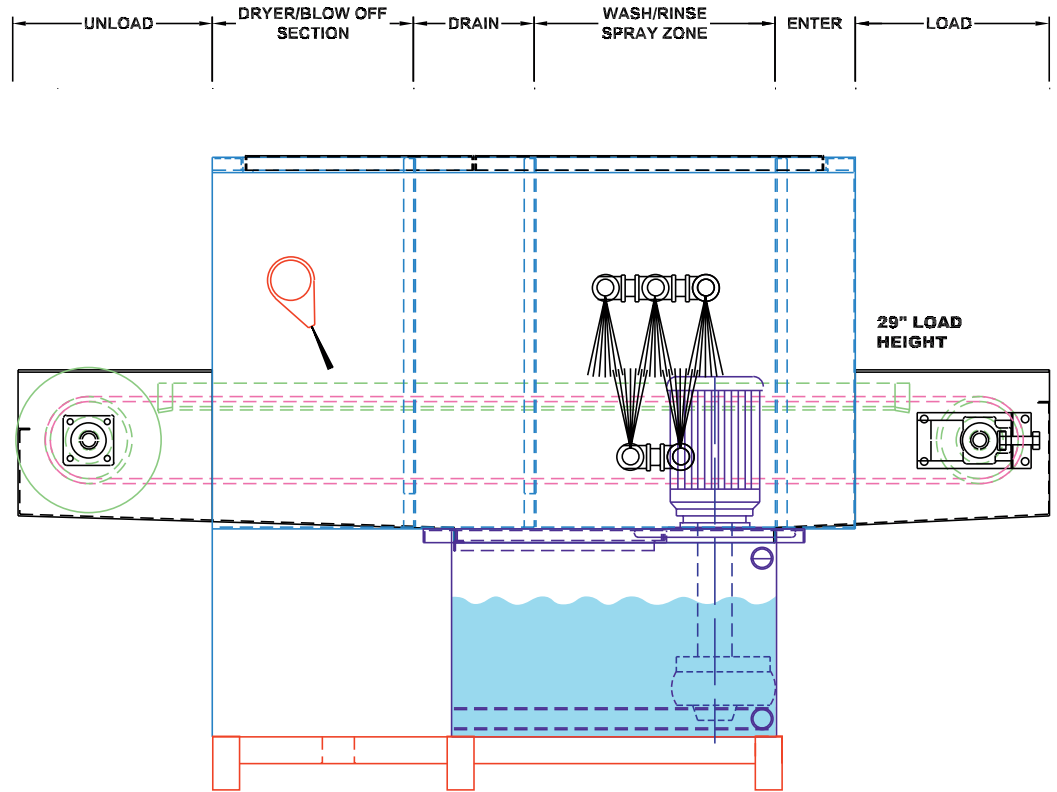
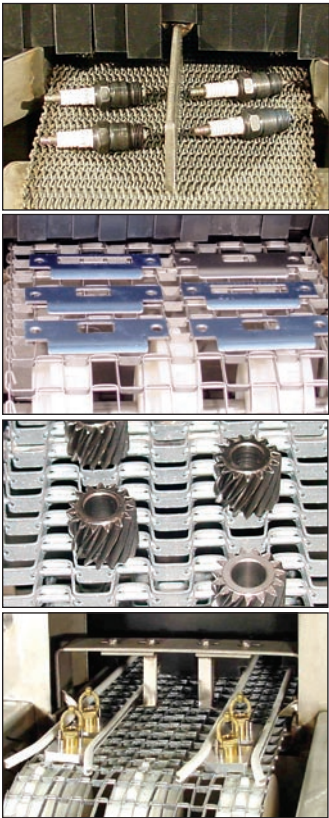

## SPECIFICATIONS

Belt Width	6" to 12"	
Tank Material	304 Stainless Steel	
Wash Tank Volume	30" DOT Tank 65 Gallons	36" DOT Tank 75 Gallons
Rinse Tank Volume	24" DOT Tank 50 Gallons	30" DOT Tank 65 Gallons
Wash Pump	20 - 60 GPM*	5 to 40 PSIG*
Rinse Pump	15 - 40 GPM*	5 to 40 PSIG*
Wash Tank Heat	140° F	Electric with Temperature Control
Rinse Tank Heat	140°F	Electric with Temperature Control
Regenerative Blow Off	24" DOT	Available Top and Bottom
Overall Width	41"	

\* Depending on part size for energy savings

## OPTIONS

- Tank Insulation
- Chip Basket Solution Strainers
- Additional and/or Longer Tanks
- Filters
- Disc, Belt or Coalescing Oil Separator
- Tank Heat to 180° F
- PLC Control
- Stainless Pumps and Piping
- Heated Blow Off
- Variable Belt Speed
- Casters
- Return to Operator Design
- Inclined Belt Immersion and Spray Washers



**Jensen Fabricating Engineers, Inc.**

555 Wethersfield Rd., Berlin, CT 06037

Phone: (860) 828-6516 Fax: (860) 828-0473

Visit: [www.jenfab.com](http://www.jenfab.com) Email: [salesinfo@jenfab.com](mailto:salesinfo@jenfab.com)

*Before You Buy, Test Your Parts  
in Our Production Size Test Machines*